

ReadyDose™ Specialty Beverage Cleaner Tablet



Automatic espresso machines at closing

1. Place one tablet in brew group cleaning chute.
2. Follow manufacturer's cleaning instructions.

For milk line cleaning

1. Place two tablets in 1 L of hot water.
2. Follow manual cleaning instructions.

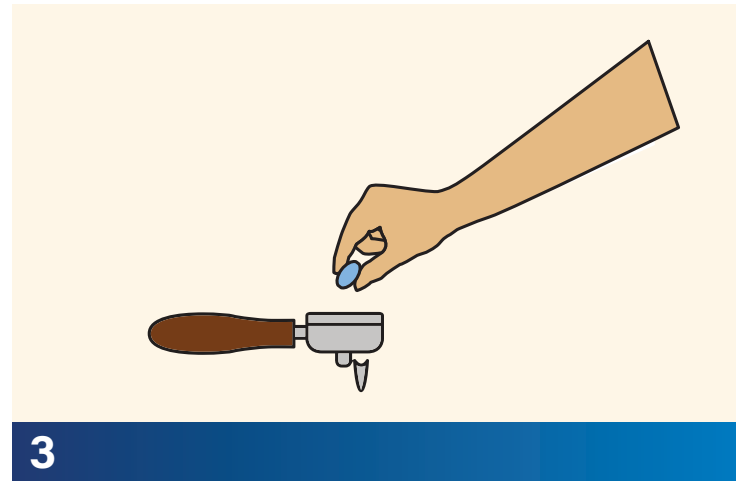

Traditional espresso machines throughout the day

1. Complete a backflush using the blind head for every 1 kg of coffee beans used.

At closing

1. Place one tablet into blind head and start cleaning cycle.
2. Run backflush cycle.
3. Run backflush cycle two times without cleaning solution.
4. Rinse, brush and wipe the dispersion screen and gasket at sink.
5. Continue to backflush until no coffee grounds are present.

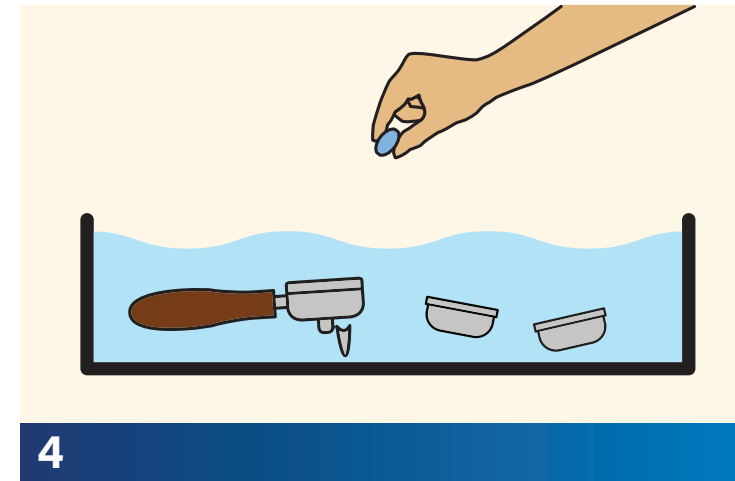

Portafilters, baskets and steam wands at closing

1. Dissolve one tablet in 1 L of hot water.
2. Soak portafilters, baskets and steam wands in solution for a minimum of 10 minutes, then remove portafilters and baskets. Scrub with a nonabrasive pad if necessary.
3. Allow steam wand to soak for an additional 5 - 10 minutes.



Coffee/tea urns at closing

1. Dissolve one tablet 3.8 L of hot water.
2. Allow to soak a minimum of 10 minutes.
3. Scrub if necessary; then rinse urn/container at sink.
4. Follow with an appropriate sanitizer. Use in accordance with label instructions. Coffee/tea brew.

Baskets at closing

1. Place one tablet per 3.8L of water in brew basket.
2. Run brew cycle into server and hold.
3. Scrub if necessary; then rinse urn/container at sink.
4. Follow with an appropriate sanitizer. Use in accordance with label instructions.

